

# 6

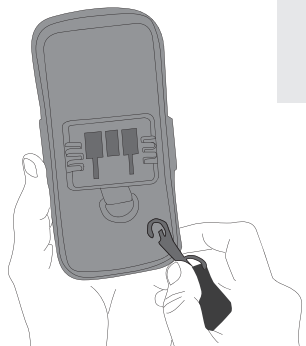

Agganciare la fascia di sicurezza alla custodia e fissare il lato terminale in velcro al tubolare del manubrio.  
Hook the safety band to the case, and fasten the Velcro closure on other end of the strap to the handlebar.

# A

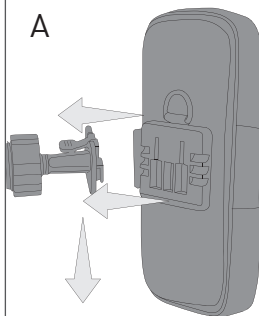

# 7

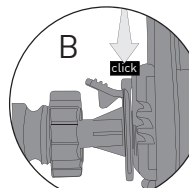

Agganciare infine la custodia alla staffa.  
Snap the case onto the bracket.

**interphone** *SMS*  
*GPS HOLDER*



ISTRSMARTIPH

**Istruzioni di montaggio**  
**Assembly instructions**



★ ★ ★ ★ ★  
★ COMPATIBILITY AND QUALITY ★  
★ GUARANTEED BY ★  
★ CELLULAR ITALIA S.p.A. ★  
www.cellularline.com/quality

AZIENDA CON SISTEMA QUALITÀ  
CERTIFICATO DA DNV  
**UNI EN ISO 9001/2000**



Distributed By: **CELLULAR ITALIA** S.p.A.

Via Lambrakis 1/A - 42122 Reggio Emilia (Italy)  
www.interphone.cellularline.com

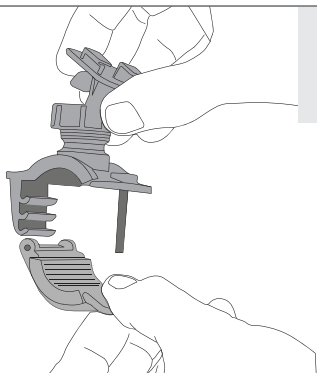
**1**

Sistema di montaggio regolabile per manubrio.  
Adjustable system for mounting on handlebar.

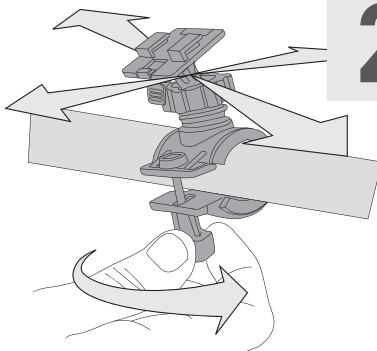
**2**

Avvitare al tubolare del manubrio e regolare a piacere l'inclinazione della basetta.  
Screw the mounting system onto handlebar and adjust the tilt of the base as desired.

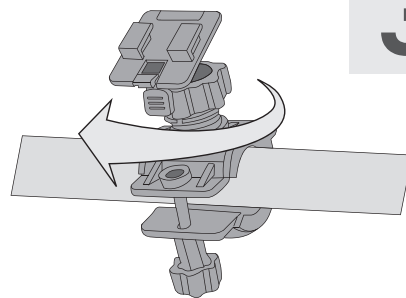
**3**

Serrare la ghiera di regolazione dell'inclinazione basetta.  
Tighten the adjustment collar on the base tilt system.

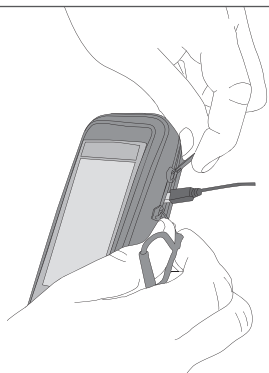
**4**

Utilizzare la doppia cerniera per il passaggio dei cavi (se necessari).  
Use the double zip to allow cables to enter the case (if necessary).

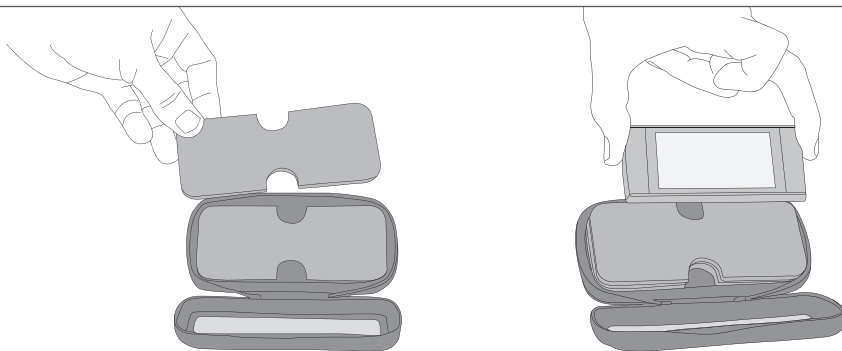
**5**

Inserire gli appositi spessori fino a che lo smartphone opportunamente spessorato tocchi la superficie trasparente della custodia.  
Insert the shims provided with the unit until the suitably shimmed Smartphone touches the clear surface of the case.